

BURBANK LED DOWNLIGHTER INSTRUCTIONS

Issue 04 on 16th September 2021

THANK YOU for buying this product. To help ensure it gives complete satisfaction please install it according to these instructions and then pass the instructions to the appropriate person for retention and future reference.

SAFETY This is a mains voltage powered product. It is designed to be installed by suitably qualified personnel only and in accordance with the applicable building and electrical regulations. Before installation or maintenance, the electrical supply to the product must be isolated.



INSTALLATION SUPPORT If installation advice or accessories are required, please contact us at the above address. We will do our best to help. When reporting a suspected fault or seeking installation support the problem is likely to be resolved most quickly if you have full product details to-hand, as well as details of when and where it was purchased.

DIMENSIONS & IP RATING

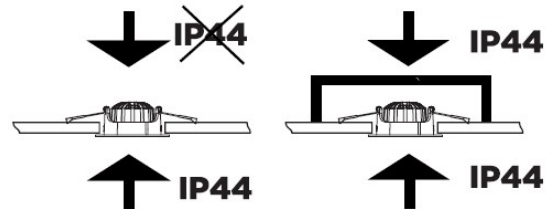
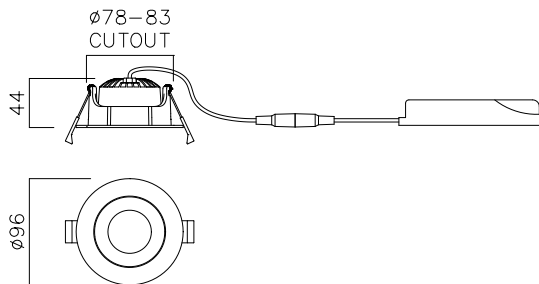

INSTALLATION

1. Decide mounting position in ceiling & cut suitable round hole, to dimension shown in diagram above & provide mains supply cable. Care should be taken when cutting the hole to avoid structures & to not exceed the specified cutting diameter so as not to expose the cut edge.
2. Expose the LED driver mains termination points by unclipping the connection cover (see diagram).
3. Route the mains supply cable(s) to the appropriate connection points on the driver unit & terminate, ensuring correct polarity is observed.

Note! Although the product is Class II, there is a spare central terminal to park the earth wire(s) if present

4. Close & secure the connection cover on to the driver unit, ensuring the cable is suitably restrained. The restraint is provided by the connection cover.
5. Locate the LED driver unit through the hole into the ceiling void. It should be placed in a suitably ventilated area to ensure prolonged life.
6. On the main fitting head unit, push & hold the mounting springs upwards.
7. Insert through the mounting hole & allow the springs to locate onto the top of the mounting surface to secure.

Note! Ensure that the void the head unit & LED driver are being fitted into is at least 30mm high (includes insulation), as this can have an affect on performance & lifetime
8. Reconnect power supply & check for correct operation.

Note! Luminaires fitted with electronic drivers are exempt from insulation resistance tests as this will cause damage to the electronic components.

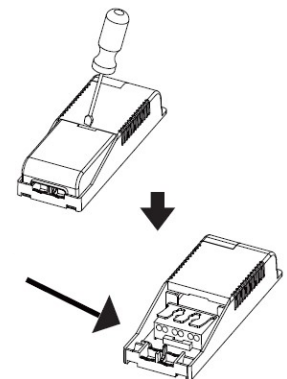

This product contains a LED light source of energy efficiency class <F>

MAINS DIMMING It is for the installer to ensure that any dimmer used with this fitting is compatible with it. NVC cannot guarantee the performance of another manufacturer's product, but we have found that the following dimmers, used in accordance with the manufacturer's guidance, give a performance that we consider to be good (others are available):

- Elko 630GLE
- Elko 314GLE
- Elko 315GLE
- Schneider 506DA219