

RENTON INSTRUCTIONS
Issue 01 December 2025

Thank you for your purchase

For best results, have this light fitting installed by a qualified electrician, following these instructions. Keep this leaflet for future reference.

Safety

- Mains powered – installation must comply with building and electrical regulations.
- Always switch off and isolate the power before installation or maintenance.



Need Help?

For advice or accessories, contact us at the address above. Please have the product name, model, and purchase details ready.

LUMINAIRE INSTALLATION

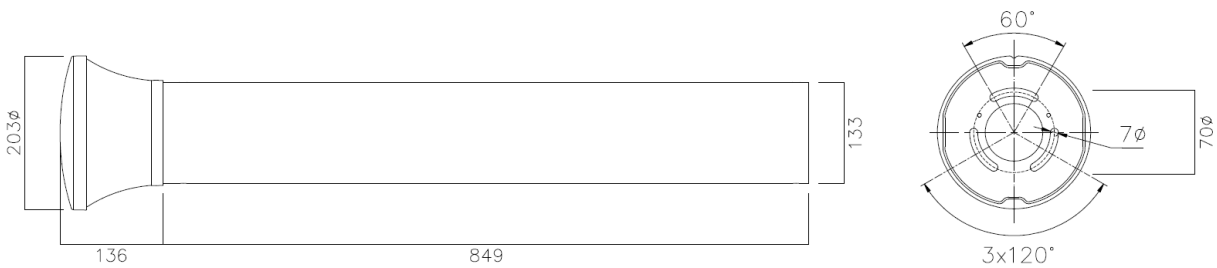

Packing List		
	Base plate templates	1pcs
	Screw fixing plate	1pcs
	Screw M5*16	6pcs
	Screw M6	3pcs
	Mut M6	3pcs

INSTALLATION

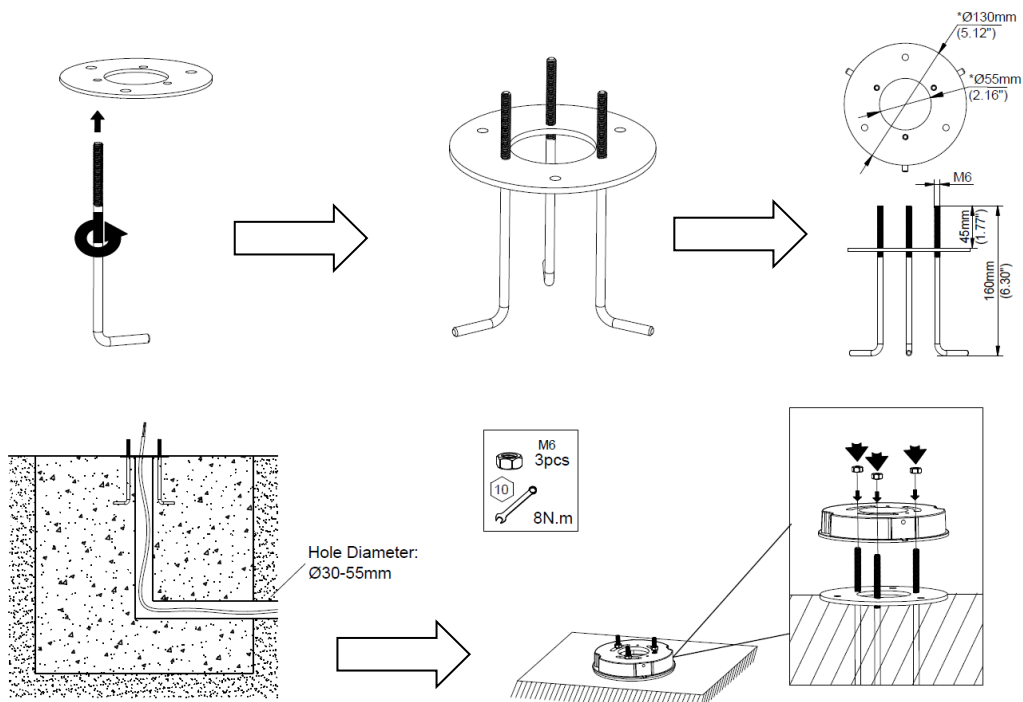

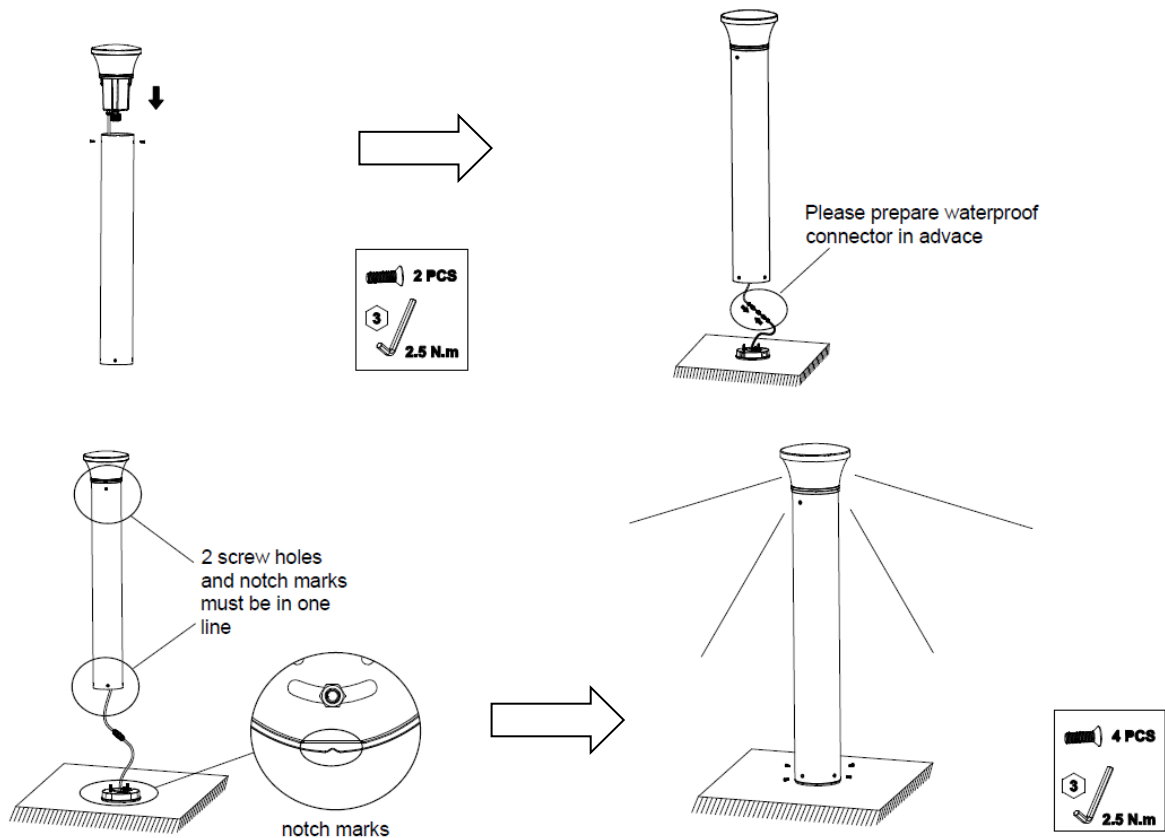

DIP-SWITCH POWER ADJUSTMENT

POWER	LUMENS
2700K	
8W	803lm
12W	1257lm
19W	1940lm
25W	2518lm
3000K	
8W	824lm
12W	1289lm
19W	1990lm
25W	2583lm
4000K	
8W	829lm
12W	1315lm
19W	2043lm
25W	2725lm

WARNING: DO NOT perform an insulation test.

ELECTRICAL DATA

The maximum number of fixtures that can be connected per fuse:

MCB Types	Fixture Amount
B10 =	55
B16 =	88
C10 =	55
C16 =	88

MAINTENANCE

- Cleaning should be carried out at regular intervals to avoid impairing the luminaire's photometric performance or thermal safety.
- The light source and driver are replaceable. Replacement of the light source and driver should be carried out by a qualified person to ensure that the replacement is done correctly and that the product is not damaged.
- The luminaire contains a light source with energy efficiency class F in accordance with Regulation (EU) 2019/2015.

